

*received & filed
6-12-92 PKP*

**REVISED AND MODIFIED SERVICE PLAN
FOR
ST. MARY'S GLACIER METROPOLITAN DISTRICT**

JUNE, 1992

I. PURPOSE OF THIS REVISED AND MODIFIED SERVICE PLAN

The Service Plan for the St. Mary's Glacier Metropolitan District ("St. Mary's") dated February, 1977 stated that the District would provide firefighting equipment, facilities and volunteer personnel for the purpose of providing protection against fire by any available means to the property within St. Mary's.

The Clear Creek County Emergency Services General Improvement District ("County Emergency Services District") was subsequently organized in December of 1988 for the purpose of providing fire protection and other emergency services within certain unincorporated portions of Clear Creek County. On May 8, 1989 St. Mary's entered into an Intergovernmental Agreement with the County Emergency Services District which provided that the County Emergency Services District would provide fire protection and other emergency services within the boundaries of St. Mary's.

The Board of Directors of St. Mary's and the Clear Creek County Commissioners, acting as the Board of Directors of the County Emergency Services District, agree that it would be in the best interest of St. Mary's and the County Emergency Services District to have St. Mary's amend, revise and modify its Service Plan to delete the purpose authorizing St. Mary's to provide protection against fire by any available means and to supply ambulance and emergency medical and rescue services. St. Mary's has not applied any of its general property tax revenues to fire protection and emergency medical and rescue services since St. Mary's entered into the Intergovernmental Agreement with the County Emergency Services District dated May 8, 1989,

and if this proposed modification to the service plan is approved by the Commissioners of Clear Creek County, St. Mary's understands and agrees that it will not provide fire protection or ambulance and emergency medical and rescue services in the future nor apply any general property tax or other revenues to that purpose.

This proposed modification to the Service Plan is of a basic or essential nature because it represents a decrease in the level of services to be provided by St. Mary's.

Following the approval of this proposed modification to St. Mary's Service Plan, the County Emergency Services District will continue to provide fire protection and other emergency services within the boundaries of St. Mary's and levy an ad valorem property tax within said boundaries.

II. EXHIBITS

1. Legal description of boundaries of St. Mary's.
2. Map of St. Mary's boundaries.

EXHIBIT 1

Page 1 of 2

Legal Description of Boundaries
of St. Mary's Glacier Water and Sanitation District

That portion of the R. O. Phillips Placer Mining Claim, U. S. Survey Lot No. 1356, The Rockwood No. 2 Placer Mining Claim, U. S. Survey No. 2082, and the Lincoln Placer Mining Claim, U. S. Survey Lot No. 2080, falling within the following description: Beginning at Corner No. 6, Survey No. 2080, Lincoln Placer Claim; thence North 3300 feet to Corner No. 7; thence East 1320 feet to Corner No. 8; thence South 390 feet to Corner No. 9; thence North $16^{\circ}36'47''$ East 101.9 feet to Corner No. 6, Survey No. 1356, R. O. Phillips Placer Claim; thence South $35^{\circ}8'$ East 535 feet to Corner No. 7; thence South $16^{\circ}45'$ West 24.4 feet to Corner No. 10, Survey No. 2082, Rockwood No. 2, Placer Claim; thence South 3206.6 feet to Corner No. 11; thence West 330 feet to Corner No. 1; thence South $17^{\circ}25'$ West 913.91 feet along line 1-2 of said Rockwood No. 2 Placer Claim; thence West 1051.83 feet to line 5-6 Survey No. 1356, R. O. Phillips Placer Claim; thence North $18^{\circ}40'$ West 920.43 feet to a point on line 1-2 of said Lincoln Placer Claim; thence North 659.9 feet to Line 5-6 of said Lincoln Placer Claim; thence East 300 feet to Corner No. 6 of said Lincoln Placer Claim, the place of beginning.

A part of Lincoln Placer Mining Claim, U.S. Survey Lot No. 2080; a part of the Nebraska Placer Mining Claim, U.S. Survey Lot No. 2079; a part of the G. B. Harris Placer Mining Claim, U.S. Survey Lot No. 1426; all of the Texas Placer Mining Claim, U.S. Survey Lot No. 2081; a part of the Rockwood No. 2 Placer Mining Claim, U.S. Survey Lot No. 2082; a part of the R. O. Phillips Placer Mining Claim, U.S. Survey Lot No. 1356; Upper Fall River Mining District, County of Clear Creek, State of Colorado, more particularly described as follows:

Beginning at Corner No. 5 of said Lincoln Placer Mining Claim; thence $S.89^{\circ}59'28''E.$ and along Line 5-6 of said Claim a distance of 3001.19 feet to a point, said point being 300.00 feet Westerly of Corner No. 6 and said point being on the Westerly line of a parcel described in Book 235 at Page 313 of the Clear Creek County records; thence $S.0^{\circ}02'00''W.$ and along said Westerly line a distance of 660.42 feet to a point on Line 1-2 of said Lincoln Placer; thence $S.18^{\circ}37'51''E.$ and along said Westerly line a distance of 921.38 feet to a point on Line 5-6 of said R. O. Phillips Placer; thence $S.89^{\circ}49'09''E.$ and along the Southerly line of parcel described in Book 235 at Page 313 a distance of 1050.56 feet to a point on Line 1-2 of said Rockwood No. 2 Placer; thence $S.17^{\circ}46'19''E.$ and along said Line 1-2 a distance of 868.62 feet to a point 828.00 feet South of the South line of that portion of the parcel described and conveyed by deed recorded in Book 235 at Page 313, as measured at right angles thereto; thence $N.89^{\circ}49'09''W.$ and parallel to said South line a distance of 1036.79 feet to a point on Line 5-6 of said R. O. Phillips Placer; thence $S.16^{\circ}54'08''W.$ and along said Line 5-6 a distance of 1116.34 feet to Corner No. 1 of the G. B. Harris Placer; thence $S.26^{\circ}53'25''E.$ and along the Line 1-2 of the said G. B. Harris Placer and along Line 1-2 of the said Texas Placer a distance of 4212.16 feet to said Corner No. 2 of said Texas Placer; thence $S.15^{\circ}57'55''W.$ a distance of 516.05 feet to Corner No. 3 of said Texas Placer; thence $S.20^{\circ}38'04''W.$ a distance of 1064.63 feet to Corner No. 4 of said Texas Placer; thence $N.1^{\circ}20'32''E.$ a distance of 1930.48 feet to Corner No. 5 of said Texas Placer; thence $N.49^{\circ}55'41''W.$ a distance of 2297.19 feet to Corner No. 6 of said Texas Placer;

EXHIBIT 1

Page 2 of 2

thence S.87°07'00"W. a distance of 3913.88 feet to Corner No. 7 of said Texas Placer; thence N.1°40'13"E. a distance of 500.00 feet to Corner No. 8 of said Texas Placer; thence N.77°55'59"W. a distance of 323.61 feet to Corner No. 4 of said Nebraska Placer; thence S.24°33'30"W. a distance of 50.00 feet to Corner No. 5 of said Nebraska Placer; thence N.75°22'36"W. a distance of 677.02 feet to Corner No. 6 of said Nebraska Placer; thence N.48°57'12"E. a distance of 3428.79 feet to Corner No. 4 of the said Lincoln Placer; thence N.0°02'20"W. a distance of 2485.93 feet to the true point of beginning; including therein all of the Belmont, Flora Thorne, Pilgrim and Annie May Lode Claims and a part of the Little Fred Lode Claim, all U.S. Survey Lot No. 10759, and the Maid of the Mist Lode Claim, U.S. Survey Lot No. 16093, and a part of the Saint Ignacio Lode Claim, U.S. Survey Lot No. 18633, and a part of the Anna Arnold Extension Lode Claim, U.S. Survey Lot No. 16224; and excepting therefrom the following described Forest Land: beginning at Corner No. 2 of the said Lincoln Placer Mining Claim; thence S.89°58'31"E. a distance of 1193.35 feet to Corner No. 7 of the Nebraska Placer Mining Claim; thence S.49°20'34"W. a distance of 2007.19 feet to Corner No. 3 of the said Lincoln Placer; thence N.14°07'49"E. a distance of 1349.09 feet to the true point of beginning, containing 511.041 net acres, more or less.

EXCEPTING AND EXCLUDING THEREFROM THE FOLLOWING DESCRIBED TRACT:

All that part of the Nebraska Placer Claim, U.S. Survey Lot No. 2079, described as follows: Beginning at a post which bears from Corner No. 7, U.S. Survey Lot No. 2079, Nebraska Placer Claim, S 73° 50' E, 373 feet; thence S 54° W, 756.34 feet to a post; thence S 63° W, 743.66 feet to a post; thence S 27° E, 150 feet to a post; thence N 63° E, 756.34 feet to a post; thence N 54° E, 743.66 feet to a post; thence N 27° W, 150.5 feet to the point of beginning, containing 5.6 acres, more or less.

EXHIBIT
2

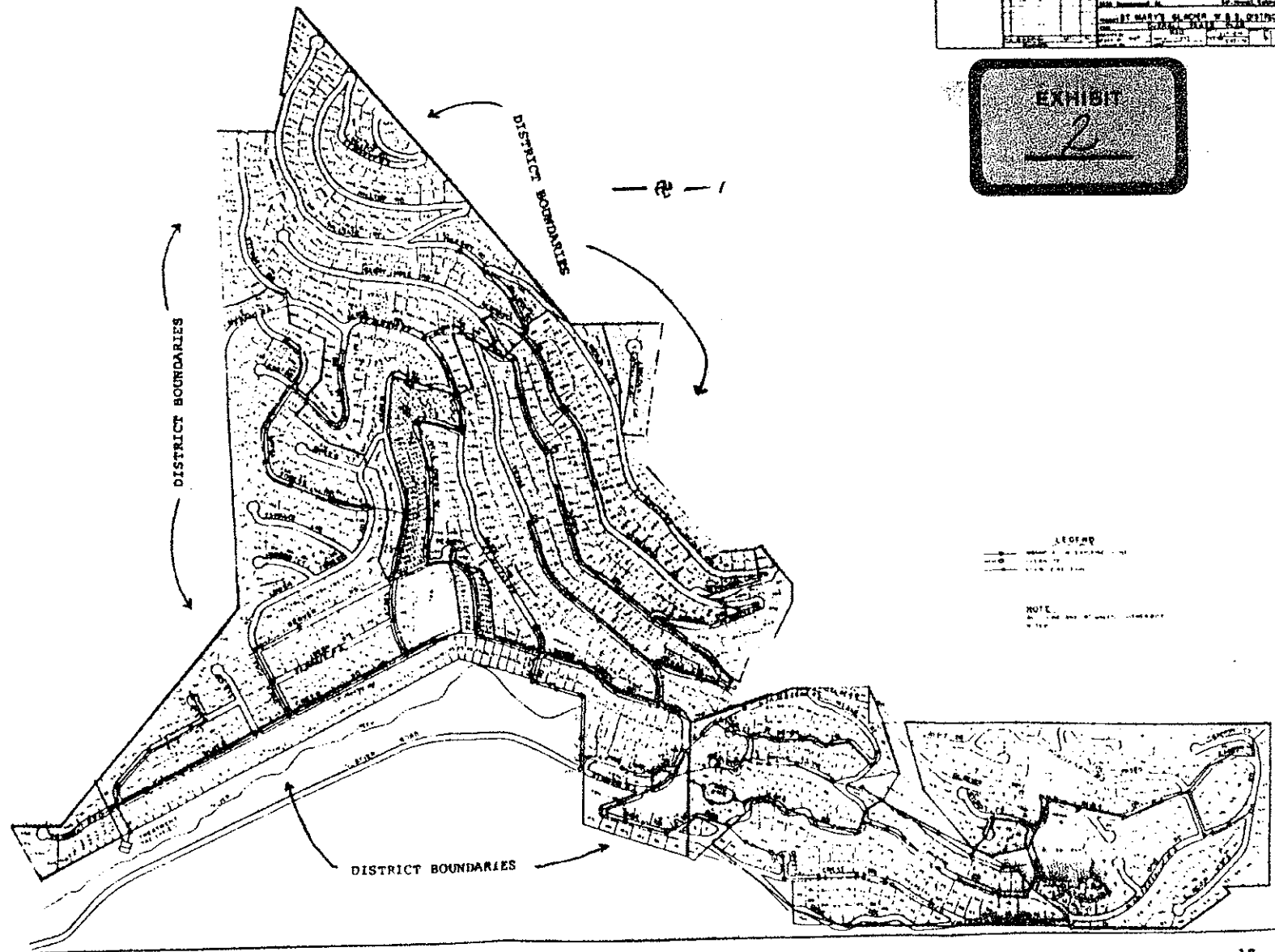

LEGEND
 --- DISTRICT BOUNDARIES
 --- DISTRICT BOUNDARIES
 --- DISTRICT BOUNDARIES

NOTE
 DISTRICT BOUNDARIES
 DISTRICT BOUNDARIES